



SIX+PAR S OPS



ELATION®

7x 20W RGBLA+UV LED Par, Outdoor Permanent Specification

DATA SHEET



KEY FEATURES

(7) 20W RGBLA+UV LED Array

3200 Lumens, 87 CRI

12° Beam Angle, 22° Lens Included

Completely Fanless Cooling

16-bit Selectable Dimming Modes and Curves

Remote LED Refresh Rate

7.5" Accessory Holder

Hard Wired (Bare Wire) IP Rated Power and Data Cables Attached

Special White Marine Grade Exterior Coating

The **SIX+ PAR S OPS** includes the same features as the standard SIX+ PAR S model but adds a CX Marine Grade exterior coating and Hard Wired (bare wire) IP-rated power and data cables and is designed for permanent marine/coastal environment installations.

The **SIX+ PAR S OPS** is a compact and rugged LED fixture that features (7) 20W RGBLA+UV LED's, which produce an ultra-wide color spectrum and high quality of light. The optical system has been carefully engineered to offer an even distribution of light and color homogenization within the beam. This fixture has been designed to offer ultimate flexibility, use it indoors or out, it's IP65 rating can handle any environment. The fanless cooling system ensures silent operation allowing it to be installed in the most noise sensitive environments.

With a six color LED array, the **SIX+ PAR S OPS** is able to offer outstanding color rendering capabilities with a high CRI of 87. This, paired with its remotely variably LED refresh frequency allows it to be easily integrated into any TV and Film application.

To expand the control capabilities on the **SIX+ PAR S OPS**, precise color temperature control via a dedicated variable CCT control channel has been integrated. Programming a six-color LED fixture can be complicated so, a CMY emulation mode has been added for users that are more familiar with that color mixing system. Furthermore, an integrated library of calibrated color presets that match the most popular gel filters has been included.

The IP65 housing can be ordered in BLACK or WHITE color and includes a dedicated diffusion lens holder and the gel frame holder can accommodate industry standard 7.5" accessories. One 20° lens is included with the fixture, and other optional lenses are also available. The single yoke design allows the fixture to be mounted using the same bolt spacing as the SIXPAR 100 for retrofit applications.

To ensure the **SIX+ PAR S OPS** can be integrated seamlessly alongside original SixPar fixtures, great care has been taken to ensure that the new LED array colors match the original. A unique SixPar Emulation DMX mode has been developed, so that the new fixtures can be controlled with the same DMX mapping as the original. The color mixing has also been calibrated to virtually emulate the White LED included in the SixPar array and an output limit master setting has been added so your new lights don't overpower any older fixtures in the rig.

The **SIX+ PAR S OPS** is an ideal fixture for Themed Environments, Hospitality or Installations where high output, small form factor, simple design and permanent installation are required.



Specifications are subject to change without notice ©Elation Professional 2025/06/03
Elation Professional USA | 6122 S. Eastern Ave. | Los Angeles, CA. 90040
323-582-3322 | 323-832-9142 fax | www.elationlighting.com | info@elationlighting.com

Elation Professional B.V. | Junostraat 2 | 6468 EW Kerkrade, The Netherlands
+31 45 546 85 66 | +31 45 546 85 96 fax | www.elationlighting.eu | info@elationlighting.eu



SIX+PAR S OPS



ELATION®

7x 20W RGBLA+UV LED Par, Outdoor Permanent Specification

SPECIFICATIONS

SOURCE

(7) x 20W RGBLA+ UV LEDs

30,000 Hour Average LED Life*

*May vary depending on several factors including but not limited to: Environmental Conditions, Power/Voltage, Usage Patterns (On-Off Cycling), Control and Dimming.

PHOTOMETRIC DATA

3200 Total Lumen Output

CRI - 87

EFFECTS

Electronic Dimmer and Strobe

Variable 16-bit Dimming Modes and Curves

COLOR

RGBLA+ UV Color Array

CMY Emulation

Variable CCT 2400K - 8500K

Virtual Gel Swatch Book

CONTROL / CONNECTIONS

9 DMX Channel Modes (1ch, 3ch, 6ch, 9ch, 9ch, 11ch, 14ch, 14ch, 20ch)

4 SixPar Emulation DMX Channel Modes (6ch, 7ch, 8ch, 12ch)

RDM (Remote Device Management)

NFC Configuration (If Equipped)

Hard Wired (Bare Wire) IP Rated Power and Data

Cables, 3 meters with the following cable options:

2-Wire- Power In & Combination DMX In/Out Cables

4-Wire- Power In, Power Out, DMX In and DMX Out Cable

SIZE / WEIGHT

Length: 7.6" (193mm)

Width: 9.5" (241mm)

Vertical Height: 9.1" (230mm)

Weight: 9.5 lbs (4.3 kg)

ELECTRICAL / THERMAL

AC 100-240V - 50/60Hz

100W Max Power Consumption

-40°F to 113°F (-40°C to 45°C)

BTU/hr (+/- 10%) 341

INCLUDED ITEMS

Safety Cable

OPTIONAL ITEMS

Gel Frame & Holder Kit

60° Lens (SIX+S WFL)

100° Lens (SIX+S XFL)

1°x 40° Lens (SIX+S L140)

10°x 60° Lens (SIX+S L1060)

4 Wire OPS Hardwire Installation Plate (HWP414)

2 Wire OPS Hardwire Installation Plate (HWP212)

ORDERING INFORMATION

SKU (U.S)	SKU (E.U)	ITEM DESCRIPTION
SIX434	1237000372	SIX+ PAR S OPS
SIX+L WFL	1223200100	60° lens
SIX+L XFL	1223200101	100° Lens
SIX+L L1060	1223200098	10°x60° Lens
SIX+L L140	1223200099	1°x40° Lens
SIX+L GFK	1621000163	Gel Frame Holder & Bumper
BD0810	1236100196	10" Black Barndoor
HWP414	Pending	4 Wire Hardwire Installation Plate
HWP212	Pending	2 Wire Hardwire Installation Plate



Specifications are subject to change without notice ©Elation Professional 2025/06/03
Elation Professional USA | 6122 S. Eastern Ave. | Los Angeles, CA. 90040
323-582-3322 | 323-832-9142 fax | www.elationlighting.com | info@elationlighting.com

Elation Professional B.V. | Junostraat 2 | 6468 EW Kerkrade, The Netherlands
+31 45 546 85 66 | +31 45 546 85 96 fax | www.elationlighting.eu | info@elationlighting.eu



SIX+PAR S OPS



ELATION®

7x 20W RGBLA+UV LED Par, Outdoor Permanent Specification

UNIT DIMENSIONS

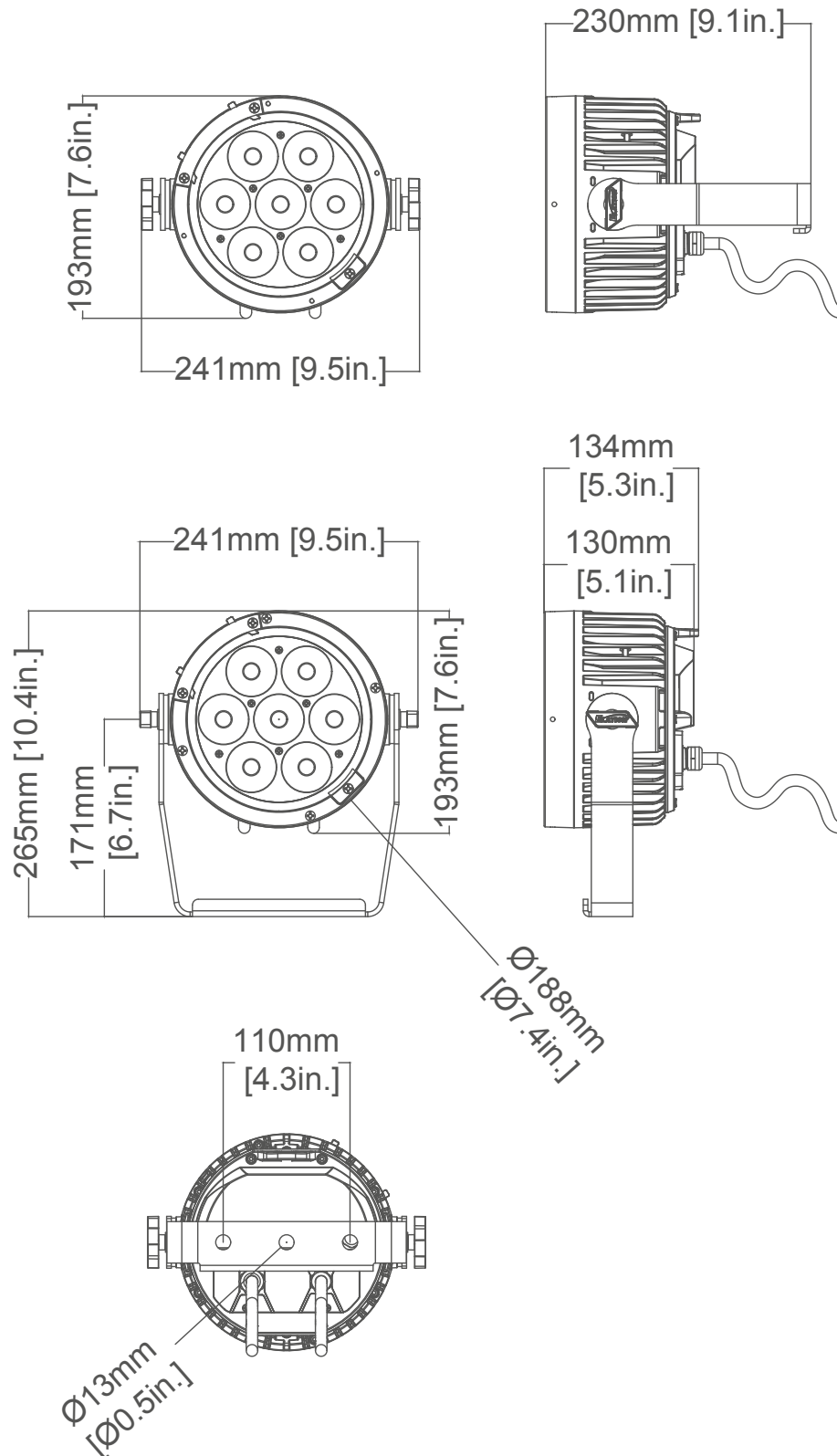

Specifications are subject to change without notice ©Elation Professional 2025/06/03
Elation Professional USA | 6122 S. Eastern Ave. | Los Angeles, CA. 90040
323-582-3322 | 323-832-9142 fax | www.elationlighting.com | info@elationlighting.com

Elation Professional B.V. | Junostraat 2 | 6468 EW Kerkrade, The Netherlands
+31 45 546 85 66 | +31 45 546 85 96 fax | www.elationlighting.eu | info@elationlighting.eu



SIX+PAR S OPS



ELATION®

7x 20W RGBLA+UV LED Par, Outdoor Permanent Specification

ACCESSORIES

HOLDER

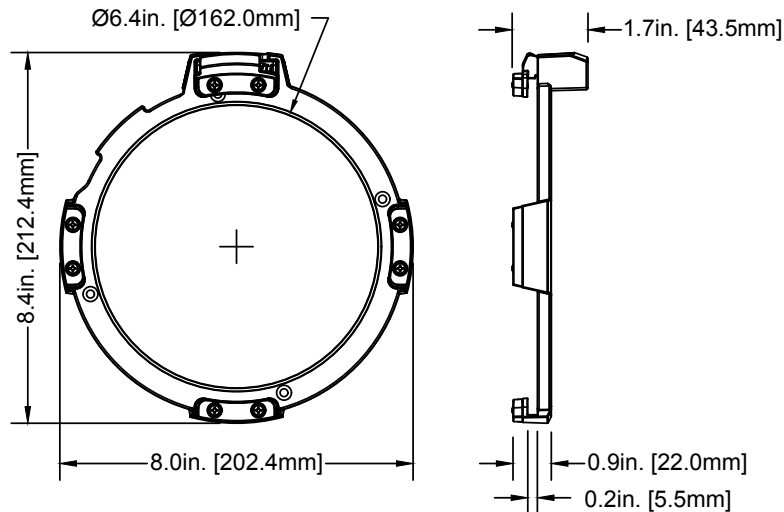

FROST FILTER

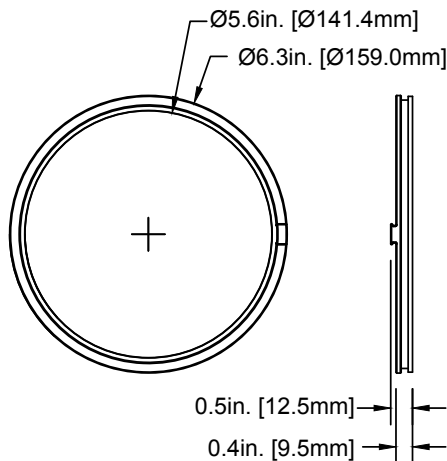

GEL FRAME

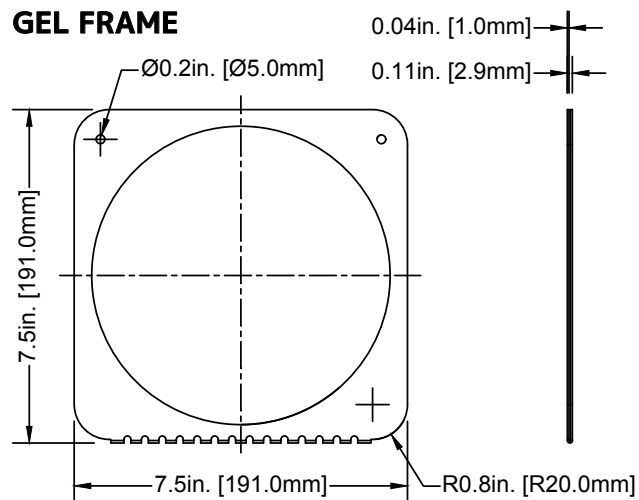

BARNDOR

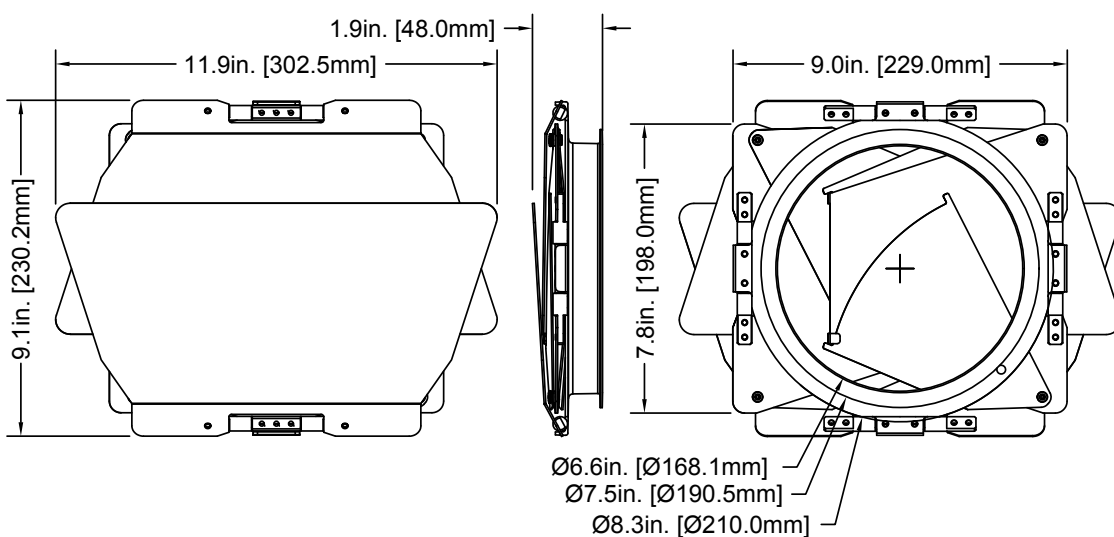

Specifications are subject to change without notice ©Elation Professional 2025/06/03
Elation Professional USA | 6122 S. Eastern Ave. | Los Angeles, CA. 90040
323-582-3322 | 323-832-9142 fax | www.elationlighting.com | info@elationlighting.com

Elation Professional B.V. | Junostraat 2 | 6468 EW Kerkrade, The Netherlands
+31 45 546 85 66 | +31 45 546 85 96 fax | www.elationlighting.eu | info@elationlighting.eu