



# CORE IP



400W Full Spectrum RGBMA LED IP65 Light Engine

**DATA SHEET**



## KEY FEATURES

400W RGBMA LED Engine

15,588 Total Fixture Lumen Output (Sphere)

Accepts 3rd Party Ellipsoidal Shutter Barrels

Stand-Alone Control with Touch Encoder and OLED Display

Direct Connection & Control for optional IP65 Gobo Rotator

NFC & Aria x2 Wireless Device Management

IP65 Rated

The **KL CORE IP** LED engine offers nearly endless functionality in a rugged and adaptable design. Central to the performance of the device is its high-output, 400W Full-Spectrum LED that is capable of delivering over 15,000 lumens of output.

The **KL CORE IP**'s fully homogenized light source makes it incredibly adaptable. For ellipsoidal applications, the fixture can be paired with an optional **KL CORE IP** Shutter Barrel and used with any of the IP67-sealed lens tubes, functioning as a traditional LED ellipsoidal. The design is also compatible with most 3rd party shutter barrel assemblies, allowing seamless integration with existing setups. Further expanding its flexibility, the optional **KL CORE IP** Fresnel Lens transforms the fixture into a zoomable Fresnel, while the optional **KL CORE IP** Bowens Mount allows it to function as a monolight or lamp head for use with softboxes, lanterns, open-face reflectors, or other beam modifiers, making it ideal for TV/film and broadcast applications.

The **KL CORE IP** offers outstanding color rendering with a high CRI of 94.9 and TLCI of 95, fully variable 16bit CCT control, and remotely adjustable LED refresh frequency. The integrated touch bar encoder allows the device to be easily controlled in stand-alone applications, and the Aria x2 wireless device management integration also offers additional control options. Configuration is made simple with the use of onboard NFC.

While the IP65-rating of the **KL CORE IP** keeps it safe in the harshest outdoor environments, it also ensures the device will work well for any indoor application too- helping to keep the fixture cleaner and dust free over long periods of time.

With its exceptional light quality, robust design, and unmatched flexibility, the **KL CORE IP** is the ultimate fixture for professionals who need a high-performance solution that adapts to a wide range of lighting requirements.



Specifications are subject to change without notice ©Elation Professional 11/26/2025  
Elation Professional USA | 6122 S. Eastern Ave. | Los Angeles, CA. 90040  
323-582-3322 | 323-832-9142 fax | [www.elationlighting.com](http://www.elationlighting.com) | [info@elationlighting.com](mailto:info@elationlighting.com)

Elation Professional B.V. | Junostraat 2 | 6468 EW Kerkrade, The Netherlands  
+31 45 546 85 66 | +31 45 546 85 96 fax | [www.elationlighting.eu](http://www.elationlighting.eu) | [info@elationlighting.eu](mailto:info@elationlighting.eu)



# CORE IP



400W Full Spectrum RGBMA LED IP65 Light Engine

## SPECIFICATIONS

### SOURCE

400W 6,000K RGBMA LED Engine  
20,000 Hour Average LED Life\*

\*Test lab conditions. May vary depending on several factors including but not limited to: Environmental Conditions, Power/Voltage, Usage Patterns (On-Off Cycling), Control, and Dimming.

### PHOTOMETRIC DATA

Total Lumen Output:  
15,588 (Integrating Sphere)  
CRI 94.9  
TLCI 95

### EFFECTS

Variable Strobe Rate: 1- 20Hz  
Dim-to-Warm/ Red Shift Emulation  
Variable 16-bit Dimming Modes and Curves

### COLOR

High Brightness and High Fidelity Output Options  
RGBMA Color Array  
CMY Emulation  
16bit Fully Variable CCT 2400K - 8500K  
Green/Magenta Shift  
Virtual Gel Swatch Book

### CONTROL / CONNECTIONS

9 DMX Channel Modes (1, 4, 6, 10, 11 19, 9, 15, 13)  
Manual and DMX Controlled Dimmer and Color  
Single Touch Bar Encoder  
4 Button Control Panel, LED Display  
Integrated IP65 Gobo Rotator Connector and Control  
RDM (Remote Device Management)  
Aria x2 Wireless Device Management  
NFC Configuration  
IP65 5pin DMX and IP65 Locking Power Cable In/Out

### SIZE / WEIGHT ENGINE DIMENSIONS

Length: 9.1" (230 mm)  
Length (Yoke 0°): 18.5" (469.8 mm)  
Width: 11.5" (292 mm)  
Height (Fixture Body): 8.9" (227.5 mm)  
Height (Yoke 90°): 18.5" (471 mm)  
Weight: 22.0 lbs (10.0 kg)

### SIZE / WEIGHT ASSEMBLED DIMENSIONS

KL CORE w/ Shutter & 14° Lens  
Weight: 32.6 lbs (14.8 kg)  
KL CORE w/ Shutter & 19° or 26° Lens  
Weight: 31.5 lbs (14.3 kg)  
KL CORE w/ Shutter & 36° Lens  
Weight: 30.9 lbs (14 kg)  
KL CORE w/ Shutter & 50° Lens  
Weight: 30 lbs (13.6 kg)  
KL CORE w/ Shutter & 70° Lens  
Weight: 33.3 lbs (15.1 kg)

### ELECTRICAL / THERMAL

AC 100-240V - 50/60Hz  
520W Max Power Consumption  
Power Thru Capacity: 7A (1 units @115V, 4 units @240V)  
5°F to 113°F (-15°C to 45°C)  
BTU/hr (+/- 10%) 1773.2

### INCLUDED ITEMS

Size 'A' Metal Gobo Holder  
Safety Cable  
IP65 Locking Power Cable

### OPTIONAL ACCESSORIES

KL CORE IP Shutter Barrel (KLC113)  
KL CORE IP Bowens Mount (KLC136)  
KL CORE IP Fresnel Lens (KLC125)  
KL CORE IP with Shutter Barrel Kit (KLC124)  
14deg IP Lens Tube (IPL014)  
19deg IP Lens Tube (IPL119)  
26deg IP Lens Tube (IPL226)  
36deg IP Lens Tube (IPL336)  
50deg IP Lens Tube (IPL450)  
70deg IP Lens Tube (IPL570)  
IP65 Gobo Rotator (IPGR01)  
4 Wire Hardwire Installation Plate (HWP404)  
2 Wire Hardwire Installation Plate (HWP202)

### APPROVALS / RATINGS

CE | cETLus | IP65 | FCC | UKCA



Specifications are subject to change without notice ©Elation Professional 11/26/2025

Elation Professional USA | 6122 S. Eastern Ave. | Los Angeles, CA. 90040  
323-582-3322 | 323-832-9142 fax | [www.elationlighting.com](http://www.elationlighting.com) | [info@elationlighting.com](mailto:info@elationlighting.com)

Elation Professional B.V. | Junostraat 2 | 6468 EW Kerkrade, The Netherlands  
+31 45 546 85 66 | +31 45 546 85 96 fax | [www.elationlighting.eu](http://www.elationlighting.eu) | [info@elationlighting.eu](mailto:info@elationlighting.eu)



# CORE IP



# ELATION®

400W Full Spectrum RGBWA LED IP65 Light Engine

## ORDERING INFORMATION

SKU (US)	SKU (EU)	DESCRIPTION
KLC102	1237000299	KL Core IP
KLC113	N/A	KL Core IP Shutter Barrel
KLC136	N/A	KL Core IP Bowers Mount
KLC125	N/A	KL Core IP Fresnel Lens
KLC124	N/A	KL Core IP with Shutter Barrel Kit
IPL014	N/A	14deg IP Lens Tube Kit
IPL119	N/A	19deg IP Lens Tube Kit
IPL226	N/A	26deg IP Lens Tube Kit
IPL336	N/A	36deg IP Lens Tube Kit
IPL450	N/A	50deg IP Lens Tube Kit
IPL570	N/A	70deg IP Lens Tube Kit
IPGR01	N/A	IP65 Gobo Rotator
HWP404	1236300104	4 Wire Hardwire Installation Plate
HWP202	N/A	2 Wire Hardwire Installation Plate



## UNIT DIMENSIONS

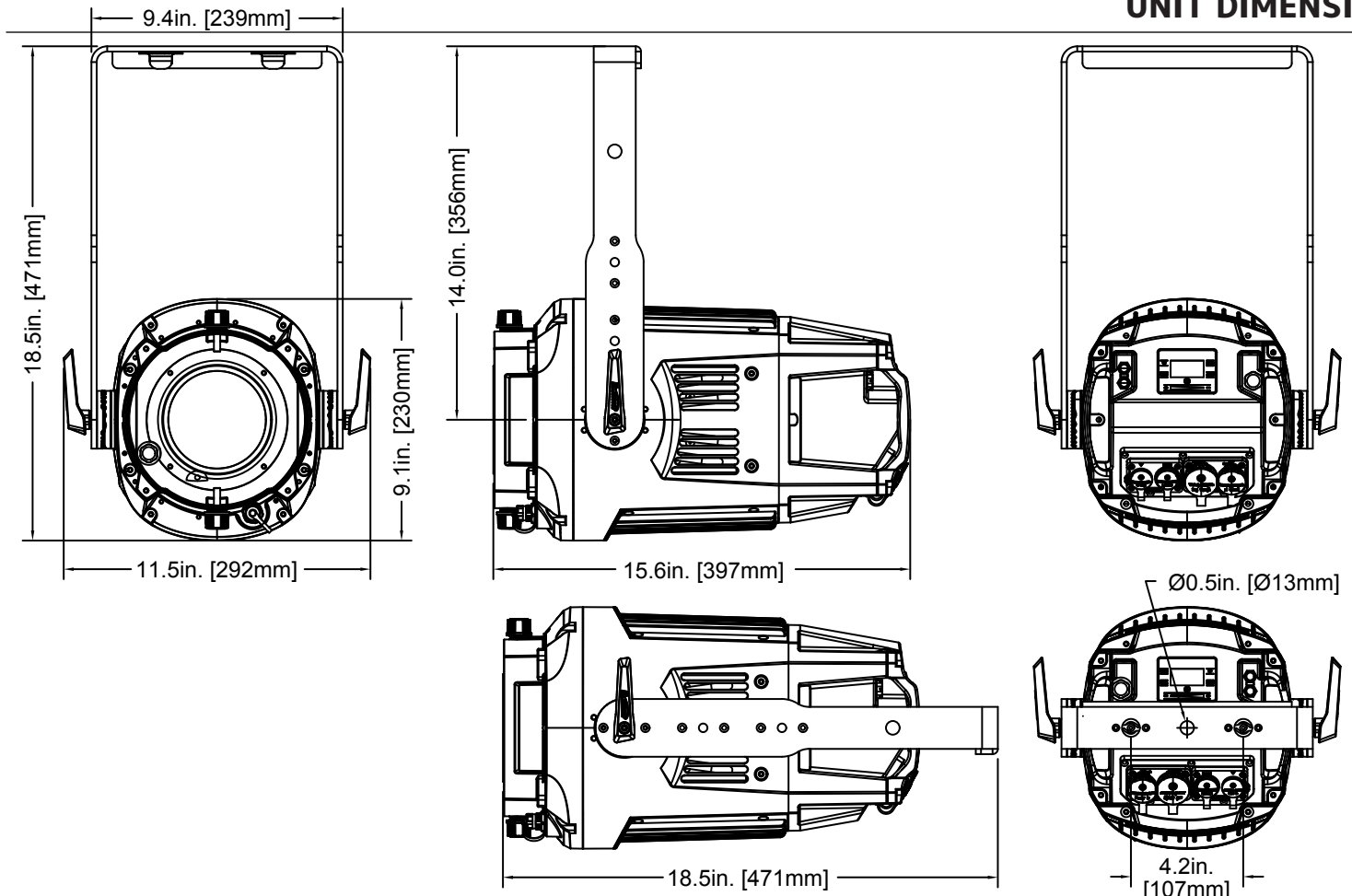

Specifications are subject to change without notice ©Elation Professional 11/26/2025

Elation Professional USA | 6122 S. Eastern Ave. | Los Angeles, CA. 90040  
323-582-3322 | 323-832-9142 fax | [www.elationlighting.com](http://www.elationlighting.com) | [info@elationlighting.com](mailto:info@elationlighting.com)

Elation Professional B.V. | Junostraat 2 | 6468 EW Kerkrade, The Netherlands  
+31 45 546 85 66 | +31 45 546 85 96 fax | [www.elationlighting.eu](http://www.elationlighting.eu) | [info@elationlighting.eu](mailto:info@elationlighting.eu)



## 14° IP LENS TUBE

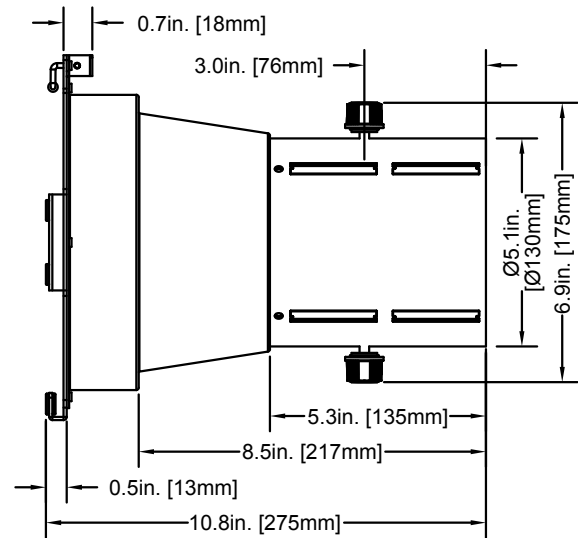
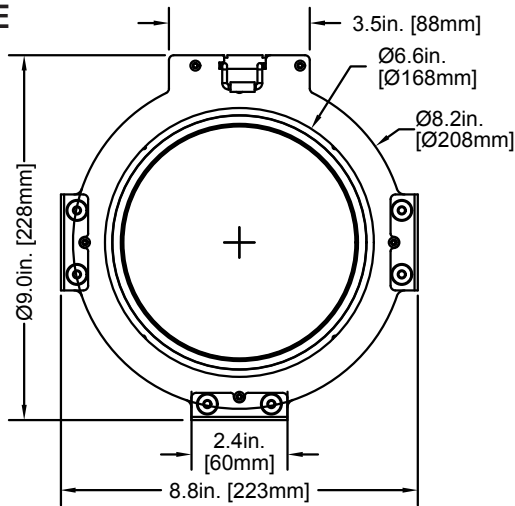

## 70° IP LENS TUBE

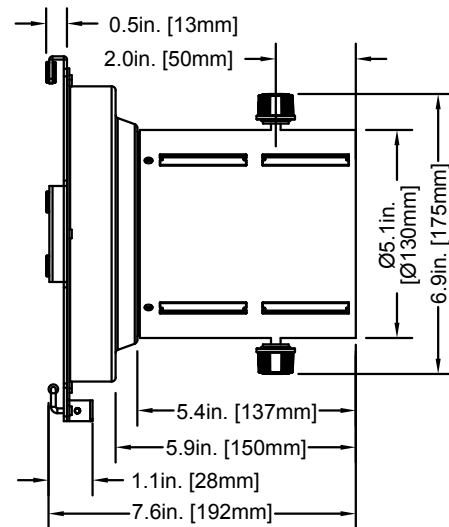
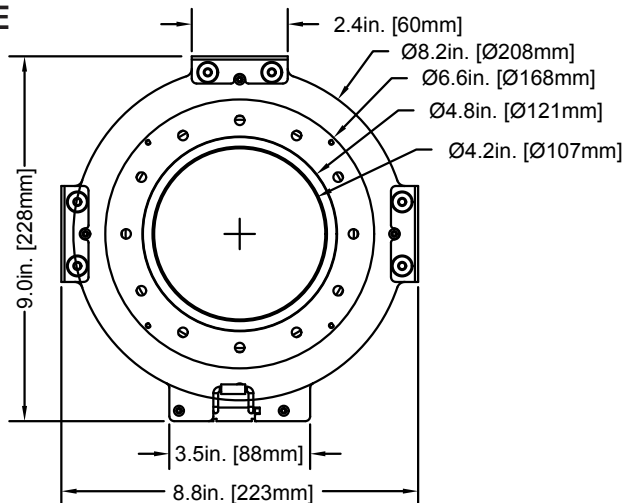

## 19°/26°/36°/50° IP LENS TUBE

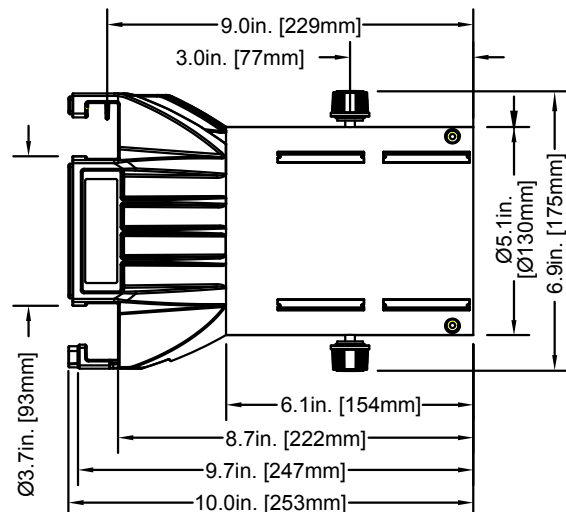
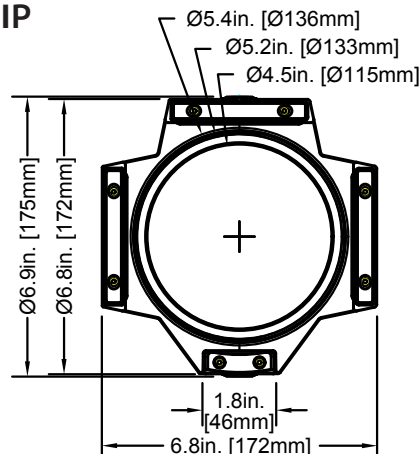



# CORE IP



# ELATION®

400W Full Spectrum RGBMA LED IP65 Light Engine

**LENS DIMENSIONS**

## FRESNEL LENS

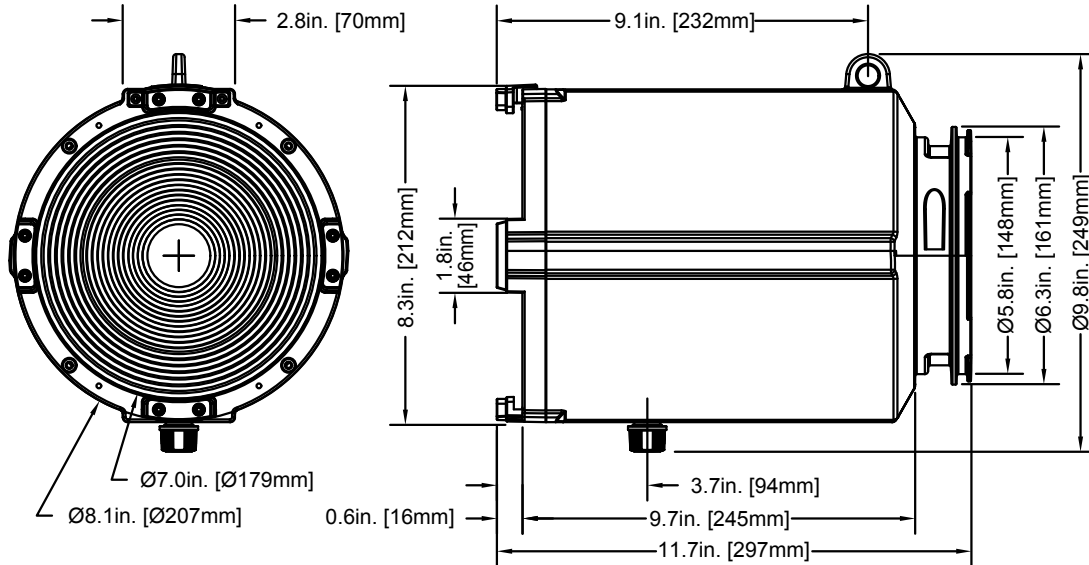

## SHUTTER BARREL

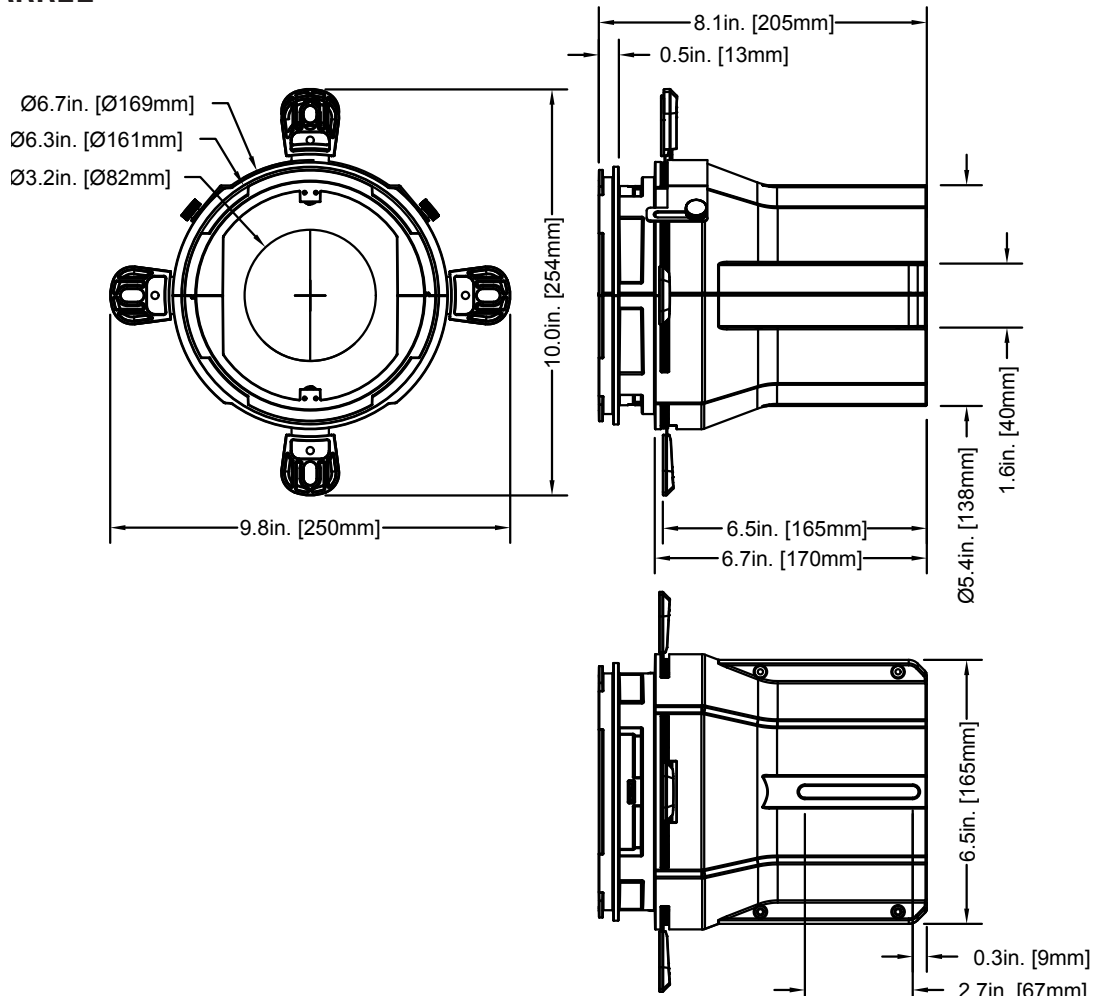

Specifications are subject to change without notice ©Elation Professional 11/26/2025  
Elation Professional USA | 6122 S. Eastern Ave. | Los Angeles, CA. 90040  
323-582-3322 | 323-832-9142 fax | [www.elationlighting.com](http://www.elationlighting.com) | [info@elationlighting.com](mailto:info@elationlighting.com)

Elation Professional B.V. | Junostraat 2 | 6468 EW Kerkrade, The Netherlands  
+31 45 546 85 66 | +31 45 546 85 96 fax | [www.elationlighting.eu](http://www.elationlighting.eu) | [info@elationlighting.eu](mailto:info@elationlighting.eu)



## GOBO CLIP

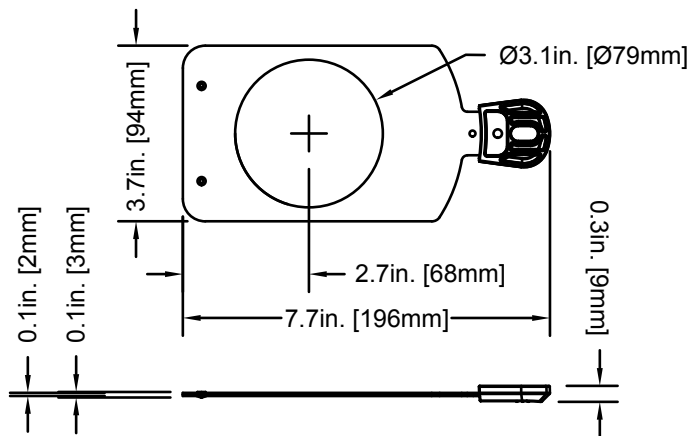

## BOWENS MOUNT

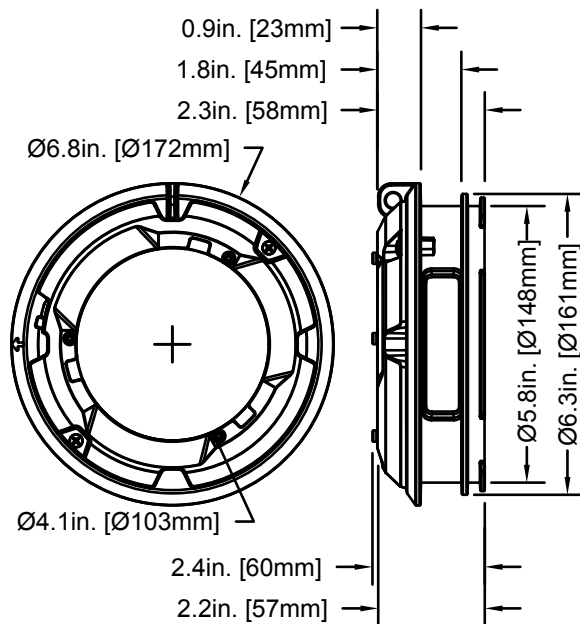

## GOBO ROTATOR

